

Modulate 1820 and 1824 (Straight)

Aug 2018

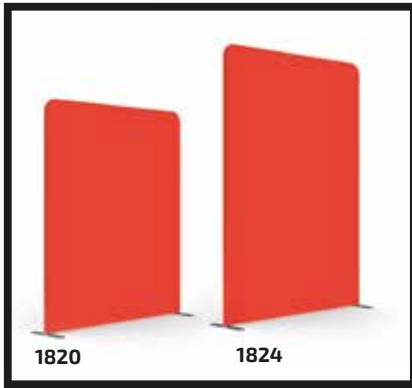

PARTS (NOT TO SCALE)

1820 Straight

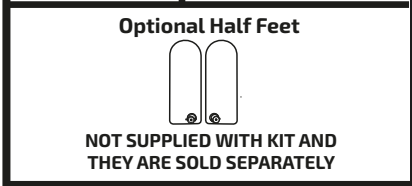
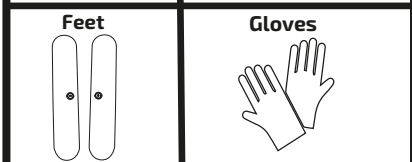
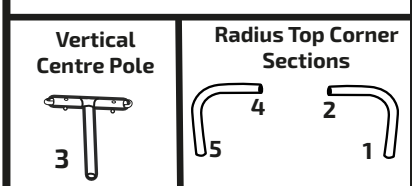
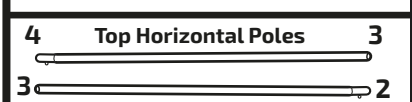
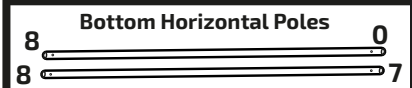
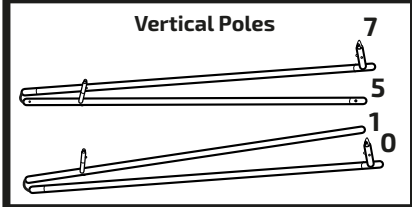

1824 Straight

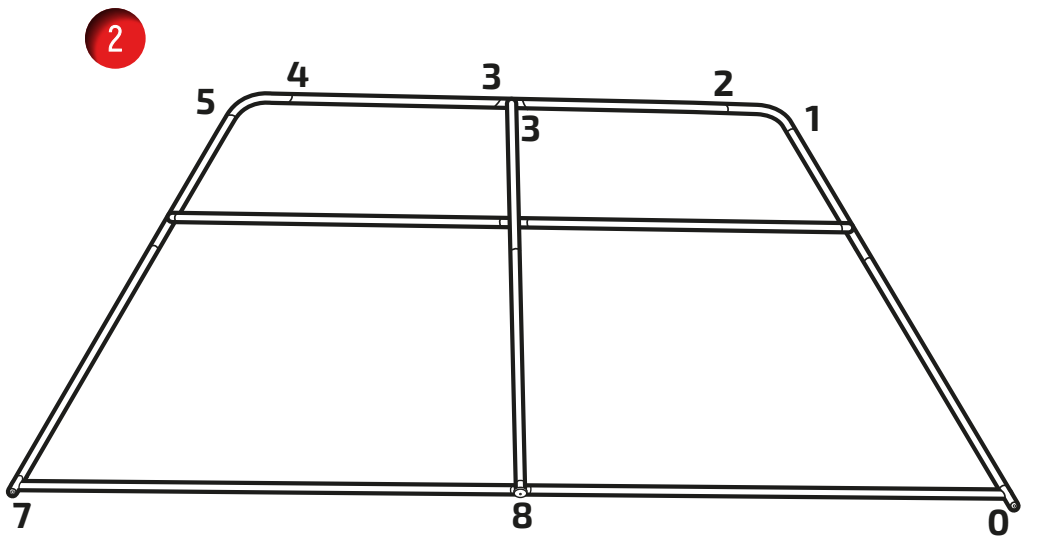
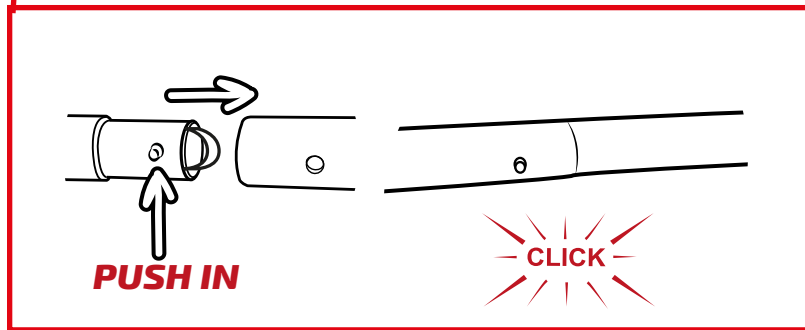
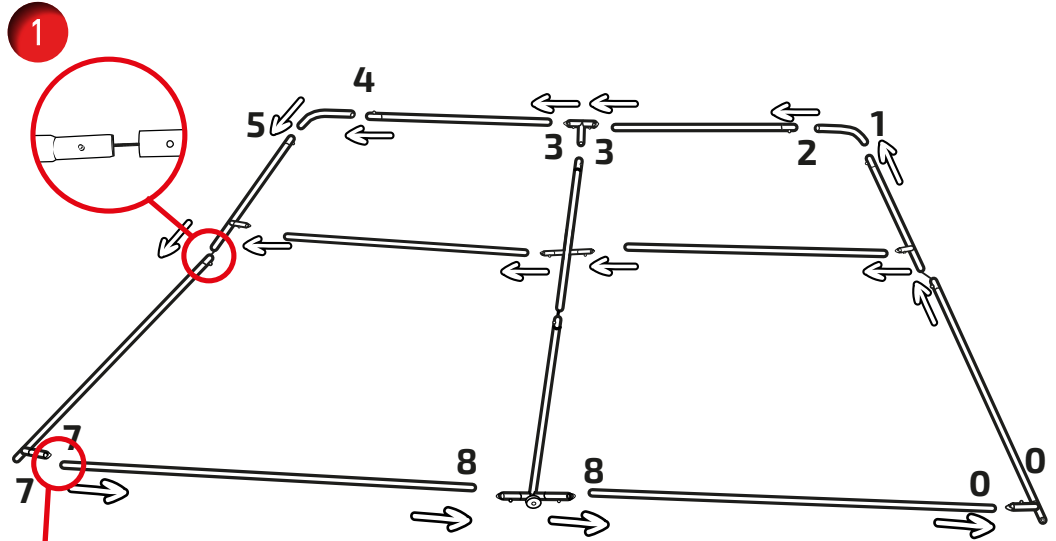
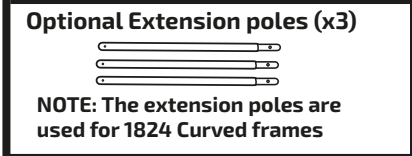

Modulate 1820 and 1824 (Straight)

Aug 2018



1

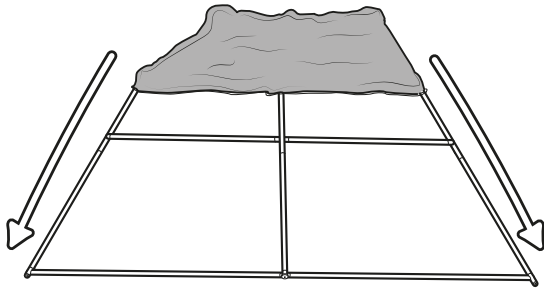

2

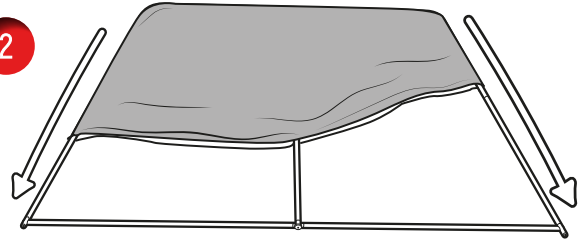

3

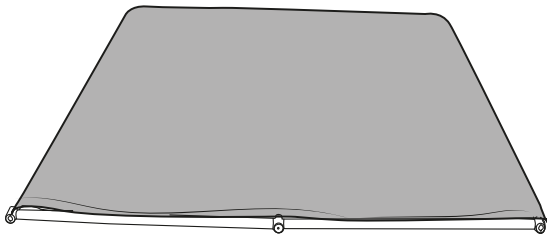

4

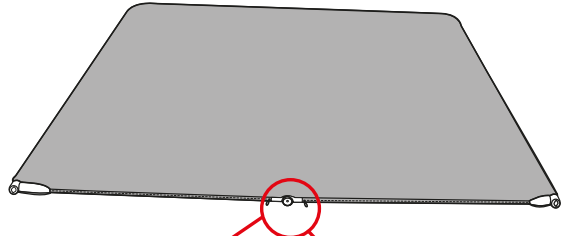

5

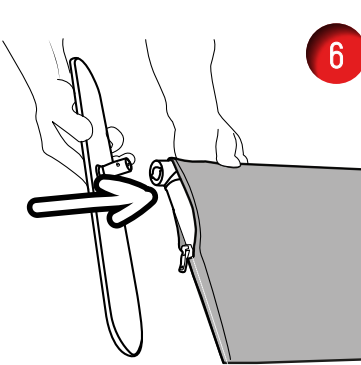

6

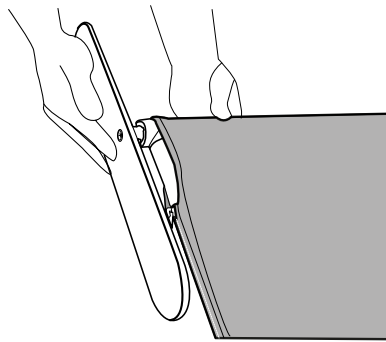

7

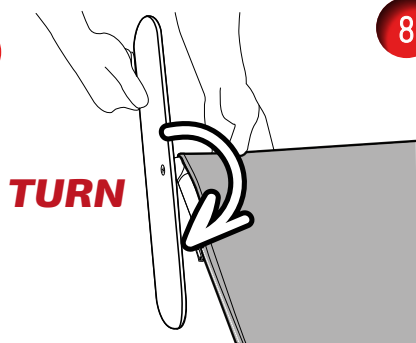

8

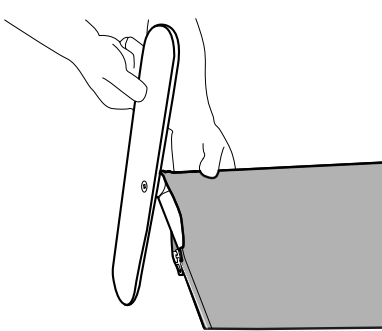

TURN

Turn clockwise to lock foot in position
Turn anti-clockwise to unlock foot

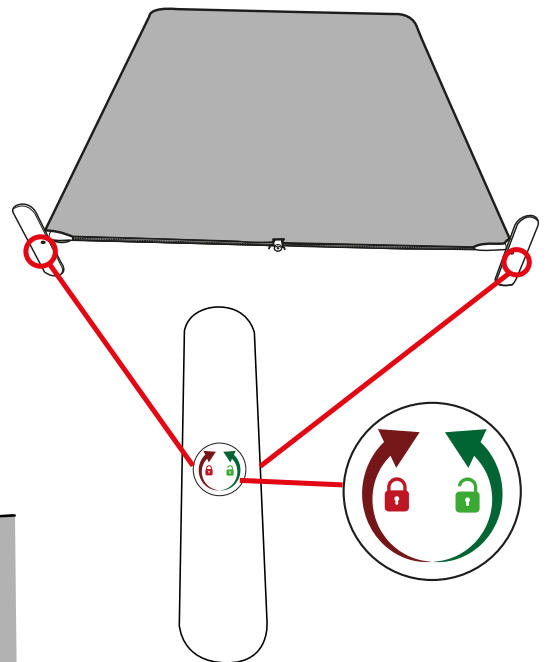

NOTE: Sticker on base of foot shows the directions for locking/unlocking foot

NOTE: TWO POSITIONS FOR THE FEET (SEE OPTION 1 FOR SECOND POSITION)



8

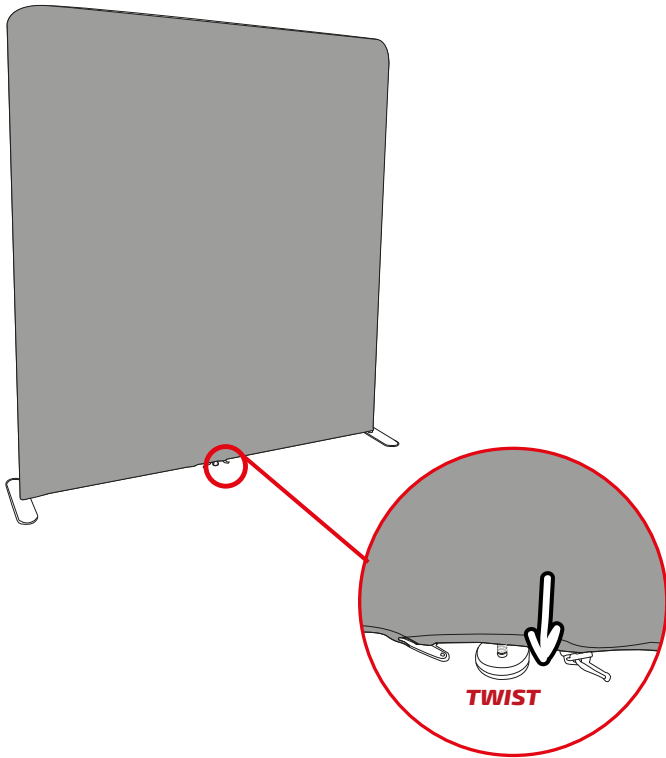

NOTE: Adjustable feet can be used to level frame

OPTIONAL (EXTENSION KIT)
NOTE: EXTENSION SECTION SUPPLIED WITH 1824 FRAME

OPTIONAL (HALF FEET)

OPTION 1 NOTE: HALF FEET CAN BE POSITIONED ONTO THE FRAME TWO DIFFERENT WAYS

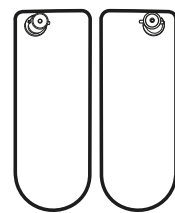
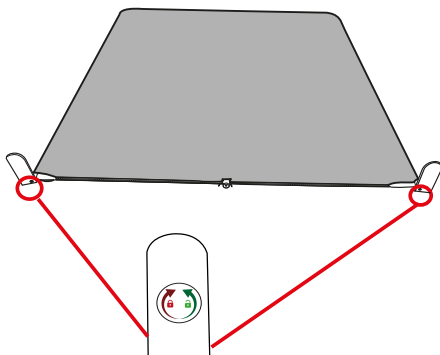
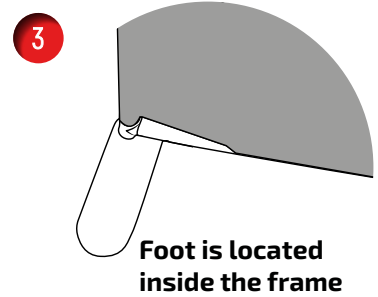
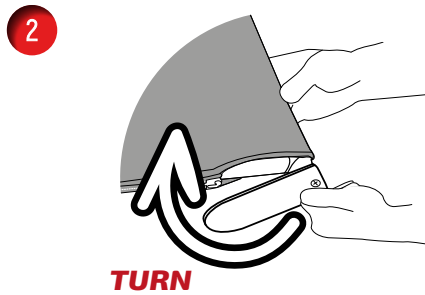
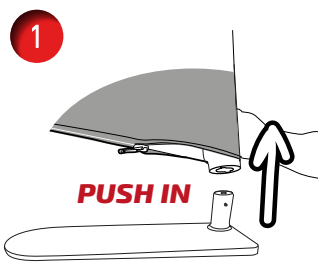

Turn clockwise to lock foot in position
Turn anti-clockwise to unlock foot



OPTION 2

1

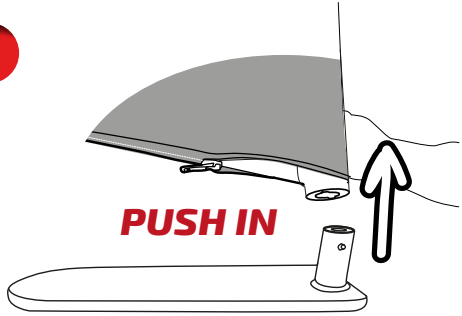

2

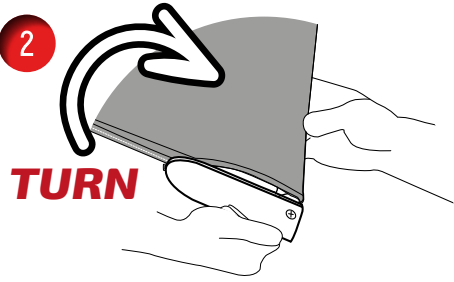

3

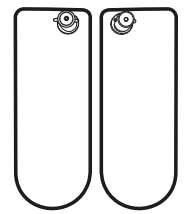
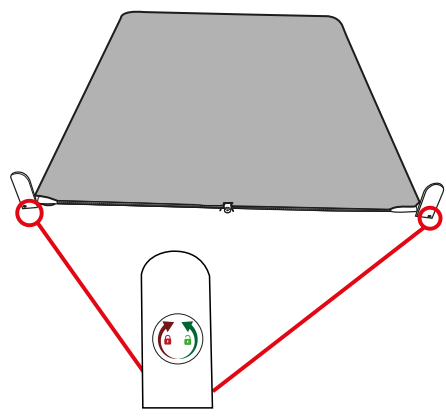
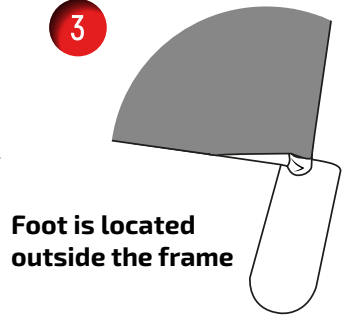

Turn clockwise to lock foot in position
Turn anti-clockwise to unlock foot

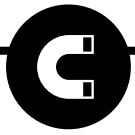

CONNECTING MULTIPLE FRAMES

NOTE: SECOND FRAME (820 STRAIGHT NOT INCLUDED)

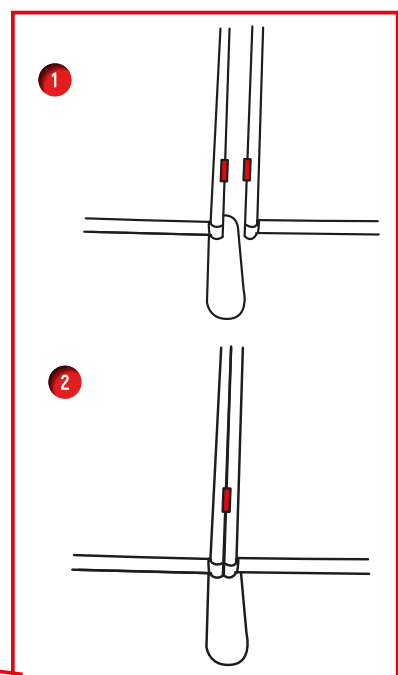
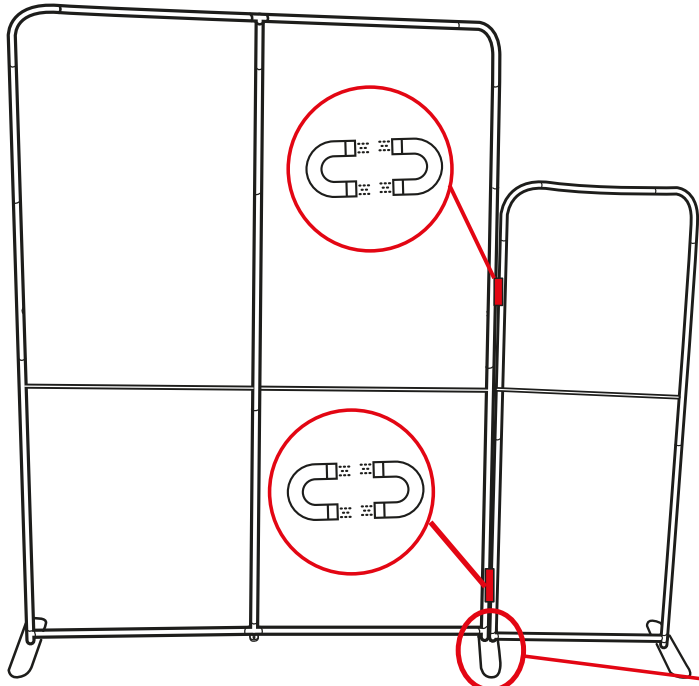

Remove one foot from second frame and align both frames on one foot

NOTE: FOLLOW OPTION 2 FOR HALF FEET TO CONNECT TWO FRAMES ON ONE FOOT

1824 (With Extension) Straight Frame and 820 Straight Frame